

TOWN OF SOUTHBURY

APPLICATION FOR ZONING PERMIT

ZONING APPLICATION FEE:	\$25.00
STATE OF CONN. FEE:	<u>\$60.00</u>
TOTAL FEES DUE:	\$85.00

ZONING PERMIT NUMBER

DATE

- ▶ SINGLE FAMILY DWELLING
- ▶ ADDITION
- ▶ ACCESSORY STRUCTURES
- ▶ POOL - INGROUND/ABOVE
- ▶ SIGNS
- ▶ HOME ENTERPRISE
- ▶ STATEMENT OF USE

NAME OF OWNER _____ PHONE _____

ADDRESS _____

ADDRESS OF PROJECT _____

BUILDER OR AGENT _____ PHONE _____

ADDRESS _____

SUBDIVISION _____

NAME	ZONE	MAP#	BLOCK#	LOT#

WIDTH OF LOT	DEPTH	% COVERAGE	ACREAGE

HEIGHT OF STRUCTURE	STORIES	SIZE OF STRUCTURE

ESTIMATE OF MATERIAL (SOIL, ETC.) TO BE MOVED: _____

LOCATE FUEL TANK	INGROUND	BASEMENT	GARAGE

*****SETBACK DISTANCES OF STRUCTURE FROM PROPERTY LINES*****

FRONT	RIGHT SIDE	LEFT SIDE	REAR LINE	STREET

Describe type of construction use / Home Enterprise (statement of use) / Sign(s): _____

Signature of Owner or Agent: _____ DATE: _____

Zoning Officials Comments: _____ DATE: _____

Approved By Zoning Official: _____ DATE: _____

PLEASE NOTE THE FOLLOWING INFORMATION:

- The Zoning Department requires a certified plot plan (A-2 Survey) showing foundation location upon submittal of the Zoning Application for all new construction of single family dwellings and Commercial structures.
- Prior to the issuance of a Certification of Zoning Compliance, an A-2 Survey is required on completion of the foundation; also the property will be inspected by the Zoning Official for compliance with the Zoning Permit that has been issued for this construction (CT General Statutes P.A. No. 84-174).
- For any other construction (additions, accessory structures, or pools – in ground/above ground, etc.) a plot plan may be drawn to scale and must show all boundaries of the property and location of all structures on the property. The Zoning Official may require a survey for verification.

SAMPLE OF TYPICAL PLOT PLAN

PLEASE SHOW SETBACK DISTANCES TO ALL PROPERTY LINES

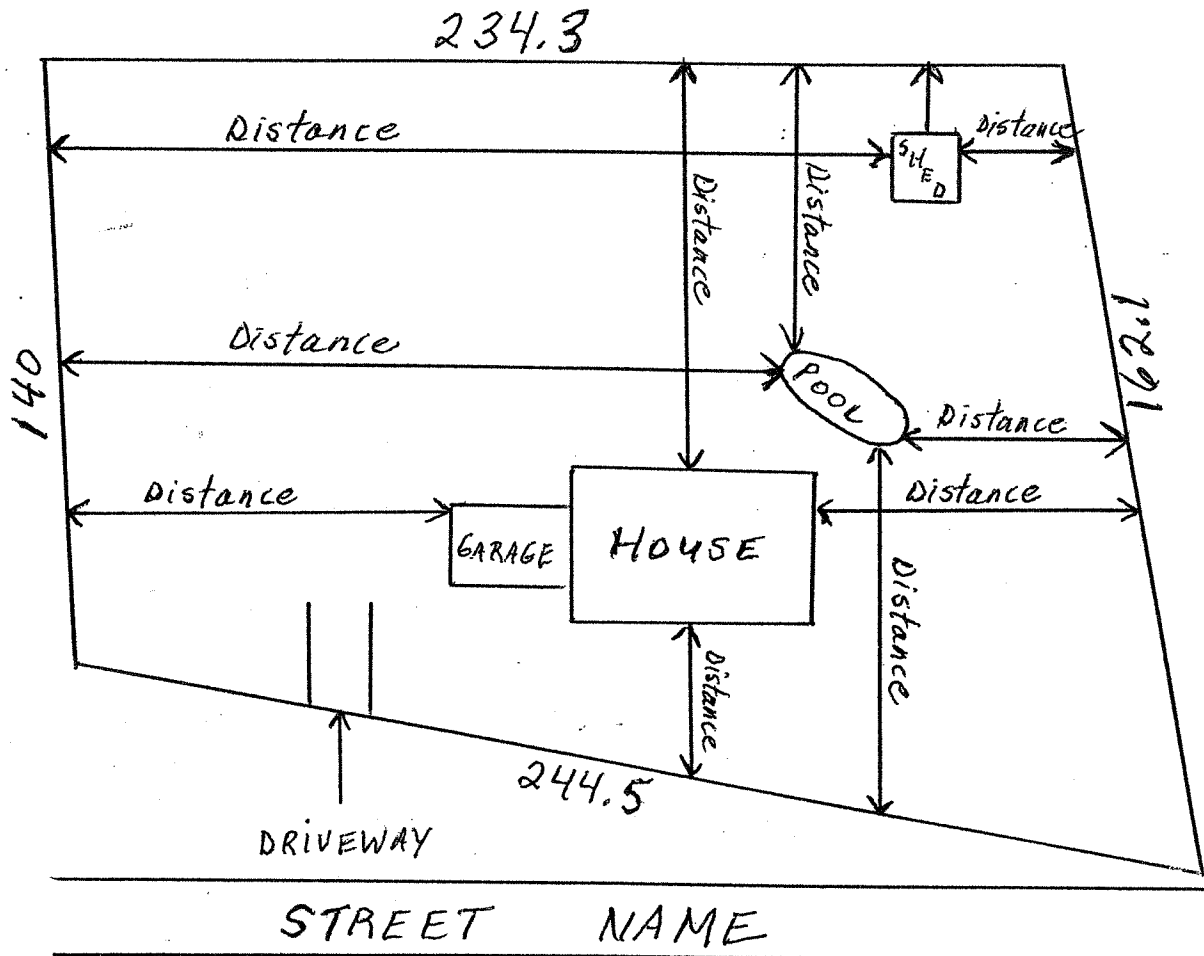

NOTES:

Scale: 1"=40'

Accuracy: Field measurements to within 1' (one foot)

Sources of Information for map:

- Record Subdivision Map
- Assessor's Map
- Survey Prepared for Owner, Surveyor, Builder, etc.